

EQUIPAGGIAMENTI  
TECNICI  
LAVAGGIO

FILTRO ASPIRAZIONE IN OTTONE  
BRASS INTAKE STRAINERS  
**FYO**



6

15/07/08

CARATTERISTICHE TECNICHE - SPECIFICATIONS

- PRESSIONE MASSIMA MAX PRESSURE	12 bar - 1.2 MPa (175 psi)
- PORTATA MASSIMA MAX FLOW RATE	G 3/8 FF - 3/8 NPT FF : 30 L/min (7.9 USG p.m.) G 1/2 FF - 1/2 NPT FF : 40 L/min (10.6 USG p.m.) G 3/4 FF : 70 L/min (18.5 USG p.m.)
- TEMPERATURA MASSIMA MAX WORKING TEMPERATURE	90° C (195°F)
- POTERE FILTRANTE STRAINING POWER	400 MICRON (45 MESH)

MISURE D'INGOMBRO - OVERALL DIMENSIONS

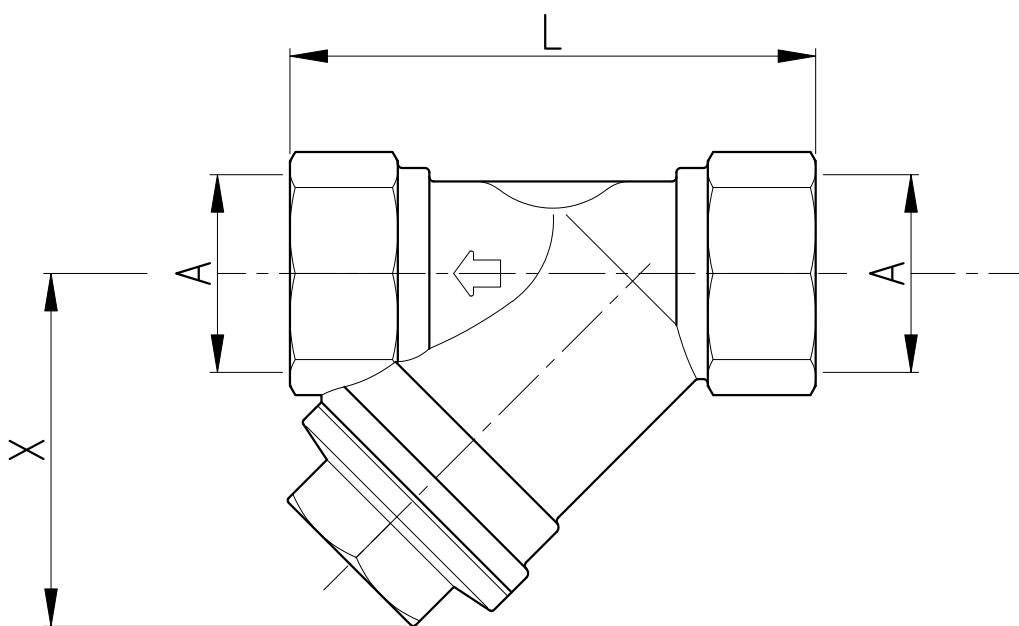

CODICE CODE	A	L	X
28.0160.00	G 3/8 FF	56 - [2.2"]	39.5 - [1.56"]
28.0162.00	G 1/2 FF	58 - [2.28"]	40 - [1.57"]
28.0164.00	G 3/4 FF	70 - [2.76"]	48.5 - [1.91"]
28.0160.50	3/8 NPT FF	56 - [2.2"]	39.5 - [1.56"]
28.0162.50	1/2 NPT FF	58 - [2.28"]	40 - [1.57"]

**28.0160.00R FYO filtro a Y ott+inox G3/8 FF**

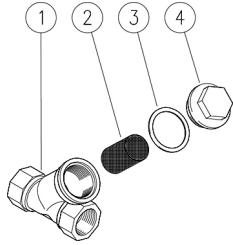

Pos.	Codice	Descrizione	Q.tà	K1	K2	K3	K4	
1	28.0166.35R	Corpo filtro Y G3/8 FF ott. (1)	1					3
2	28.0168.53R	Rete 17,5x30mm 45mesh-400µm inox	1					5
3	14.4061.00R	Guarn. 24x30x0,8 mm	1					10
4	28.0173.31R	Tappo M24x1,25 ott.	1					3

(1) 28.0160.00

**28.0160.00R FYO Y-strainer,brass+sst,3/8 FF Bsp**

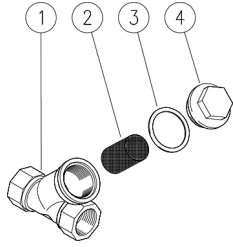

Pos.	P/N	Description	Q.ty	K1	K2	K3	K4	
1	28.0166.35R	Y-strainer housing, 3/8Bsp FF brass (1)	1					3
2	28.0168.53R	Net, 17,5x30mm 45mesh-400µm Sst.	1					5
3	14.4061.00R	Seal, 24x30x0,8 mm	1					10
4	28.0173.31R	Plug, M24x1,25 brass	1					3

(1) 28.0160.00



P.A. S.p.A.

Via Milano, 13  
42048 Rubiera, Reggio Emilia - Italy

Tel +39.0522.623611  
Fax +39.0522.629600

[info@pa-etl.it](mailto:info@pa-etl.it)

[www.pa-etl.it](http://www.pa-etl.it)



COMPANY WITH QUALITY MANAGEMENT  
SYSTEM CERTIFIED BY DNV  
= ISO 9001 =